

Drawing Name: Z:\103.0301 - Sheffield Apartments\EAF & EIS Figures\103.0301 - Alternative Sketch.dwg Date Printed: Nov 25, 2024, 12:10pm

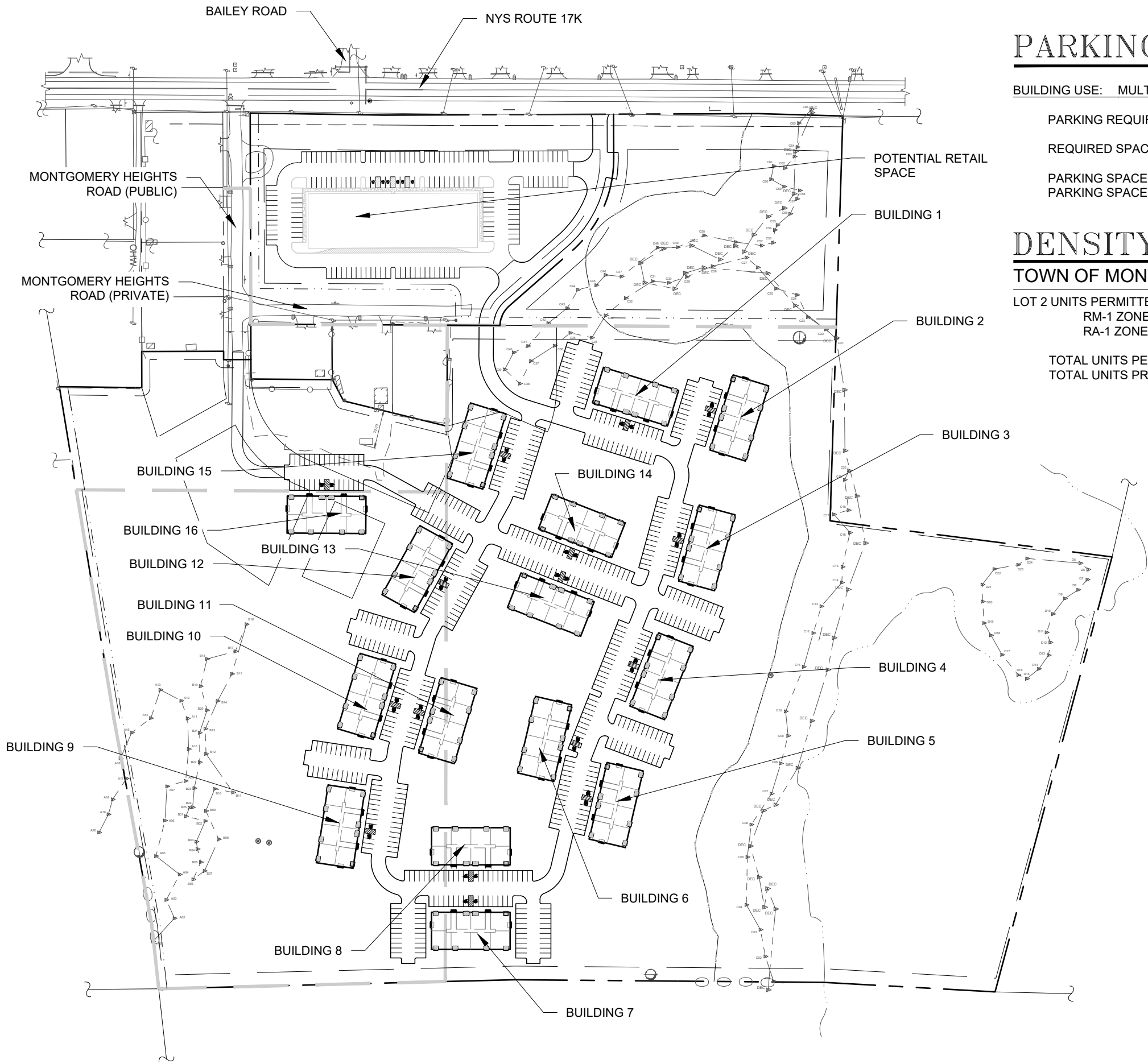

# PARKING REQUIREMENTS

BUILDING USE: MULTIPLE DWELLING (\$235 - 12.3)

PARKING REQUIREMENT: 2 SPACES PER DWELLING UNIT

REQUIRED SPACES: 261 UNITS \* 2 (SPACES/UNIT) = 522 SPACES

PARKING SPACES REQUIRED: 522 SPACES

PARKING SPACES PROVIDED: 574 SPACES

# DENSITY CALCULATIONS

TOWN OF MONTGOMERY - ZONING DISTRICT RM-1 & RA-1

LOT 2 UNITS PERMITTED:

RM-1 ZONE : 1,268,083 SF \* (1 UNIT / 5,000 SF) = 253 UNITS

RA-1 ZONE : 139,999 SF \* (1 UNIT / 16,335 SQFT) = 8 UNITS

TOTAL UNITS PERMITTED: 261 UNITS

TOTAL UNITS PROPOSED: 261 UNITS

ALTERNATE BUILDING LAYOUT	SHEFFIELD GARDENS NYS ROUTE 17K TOWN OF MONTGOMERY ORANGE COUNTY, NEW YORK	DATE: 01/23/2024 REV 11/25/2024 SCALE: 1"=250'	JOB # 103.0301 SHEET # 4.5A	<div>ENGINEERING &amp; SURVEYING PROPERTIES Achieving Successful Results with Innovative Designs</div>	<div>MONTGOMERY OFFICE 71 CLINTON STREET MONTGOMERY, NY 12549 Ph: (845) 457-7727 WWW.EP-PC.COM</div>